

RADWIN



Smart City

Powering wireless broadband connectivity in the cities of tomorrow

Municipalities worldwide are seeking to implement smart city projects to enhance public safety, improve city services, optimize infrastructure and maximize efficiency.

RADWIN's smart city solutions offer high capacity Point-to-Point (PtP) and Point-to-MultiPoint (PtMP) connectivity for smart cities as well as a unified power and communication platform for broadband and IoT applications including HD video surveillance, municipal Wi-Fi, building connectivity, smart lighting and smart parking.

RADWIN Solutions for smart cities

Accelerating and simplifying smart city deployments

RADWIN's solutions for smart cities include three main elements: Point-to-Point backhaul, Point-to-MultiPoint for fiber-like connectivity to different nodes (e.g., buildings, CCTV sites) and the Smart-Node power and communication solution.

RADWIN JET PtMP highlights:

- » High capacity (up to 750 Mbps per sector)
- » Bi-directional beamforming antenna
- » Exceptional interference immunity
- » Supports unlicensed and licensed bands
- » Guaranteed SLA

RADWIN 2000 PtP highlights:

- » High capacity (up to 750 Mbps)
- » Long range (up to 120 Km/75 miles)
- » Configurable asymmetric capacity
- » Dynamic channel bandwidth selection
- » Ruggedized IP67 outdoor unit

RADWIN Smart-Node highlights:

- » 5-Port Gigabit PoE switch & SFP Gigabit port
- » AC or DC input power options
- » Lithium-ion battery backup (UPS)
- » Unified power and networking management
- » Integration with IoT devices

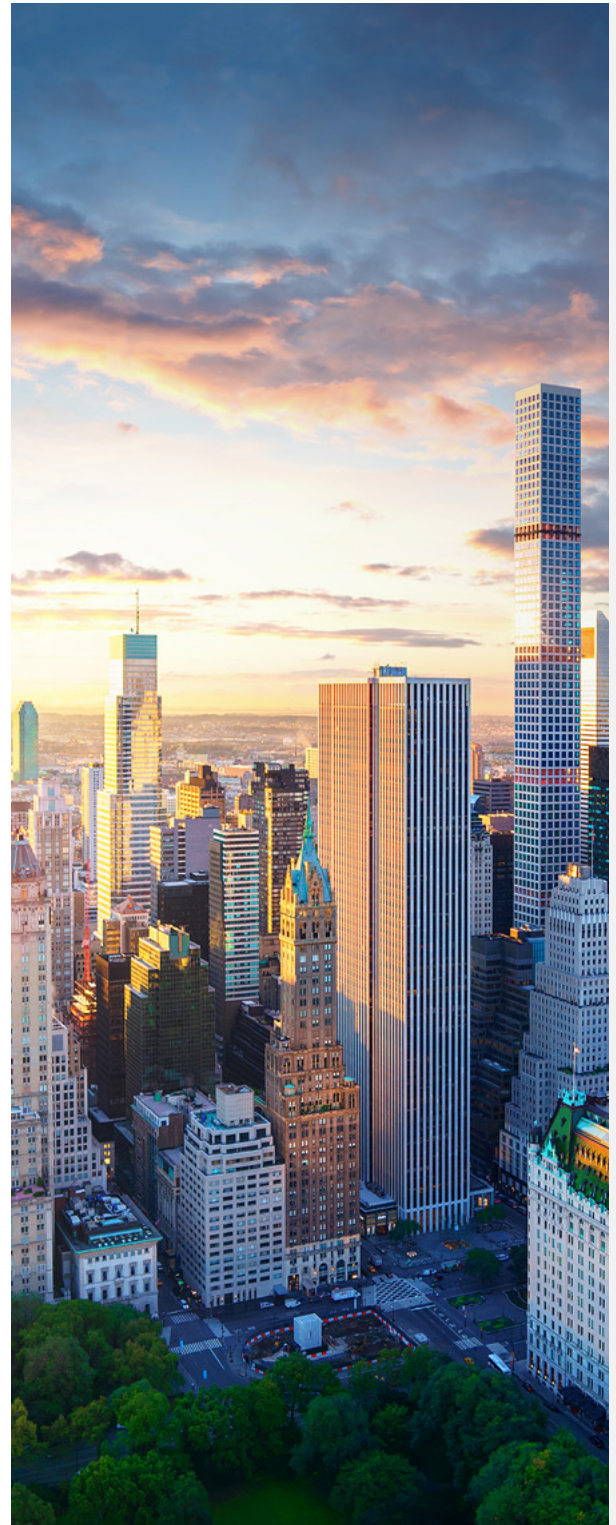

Key solution benefits

- » Greater base station capacity for broadband and IoT applications
- » Exceptional interference immunity, utilizing PtMP beamforming technology
- » High performance, even for demanding applications and in harsh environments
- » Greater flexibility by supporting different power and communication interfaces
- » Lower Total Cost-of-Ownership

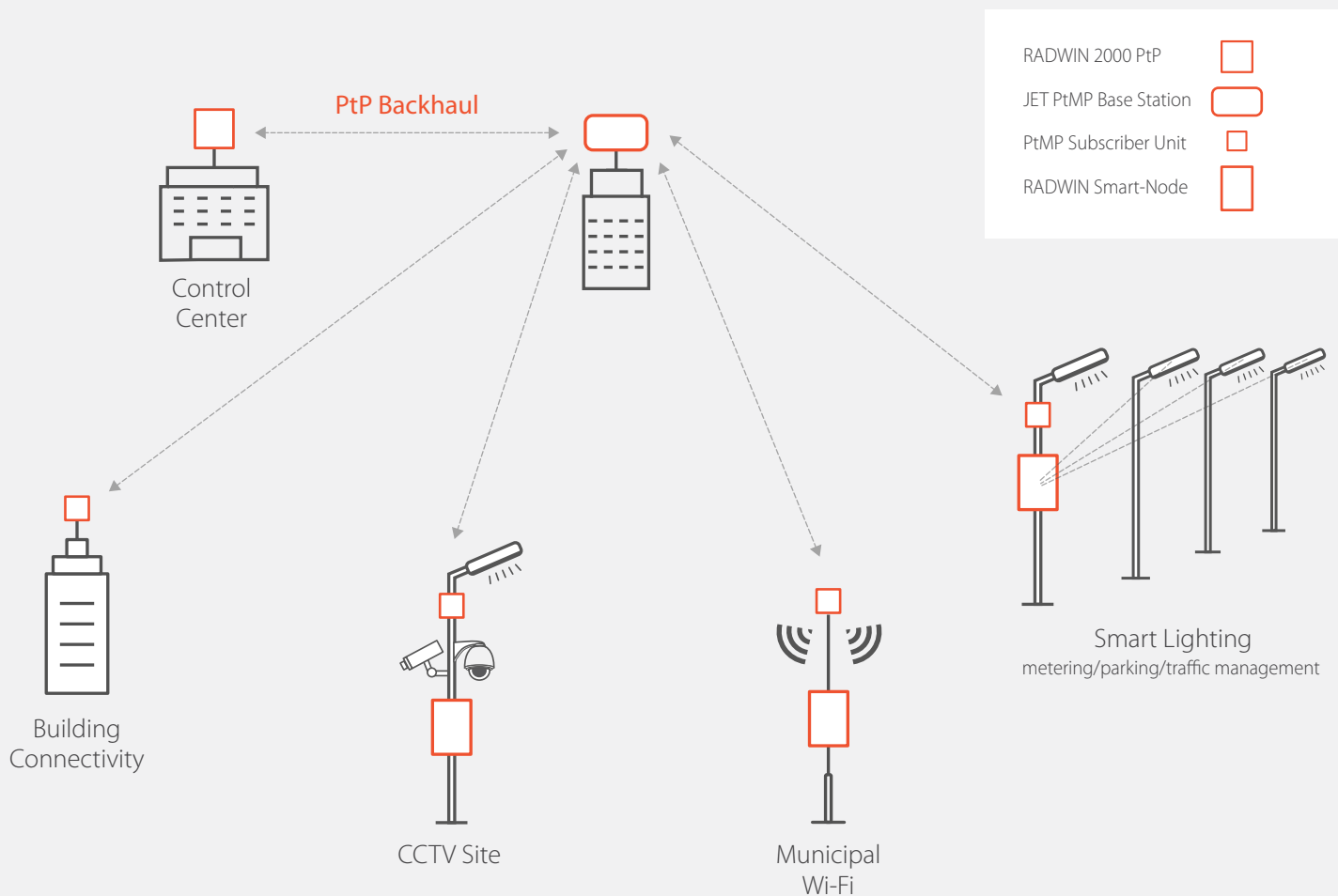

Technical Data

	RADWIN JET-PRO	RADWIN 2000
Type	Point-to-MultiPoint	Point-to-Point
Net Aggregate Throughput	Up to 750Mbps	10Mbps up to 750Mbps
Range	Up to 40Km/ 25miles	Up to 120Km/ 75miles
Frequency Multi-Band	4.9-5.9GHz 3.3-3.8GHz, 3.65 GHz	2.3-2.4GHz, 3.3-3.8GHz, 4.9-6GHz, 5.7-6.4GHz
MIMO/Antenna Diversity	Supported	Supported

	RADWIN Smart-Node	
Versatile power options	Input power options » AC: 100-240 VAC » DC: 40-57 VDC	Output power options » PoE, PoE+ (15W/30W/60W) » Passive PoE (24V/56V) » DC-OUT (12V/24V)
Versatile communication options	GbE switch » 5-Port Gigabit PoE switch » SFP Gigabit port	Wired and wireless » Fiber - SFP » Copper - LAN » Wireless broadband (external)
Unified power and networking management	» Remote power and networking management » Switch PoE assignment per port (802.3 af, at, at+ [60W], 24V/56V) » Lithium-ion battery backup (UPS) monitoring » Graceful power degradation by priority	

RADWIN is a leading provider of Point-to-Multipoint and Point-to-Point broadband wireless solutions. Incorporating the most advanced technologies such as a beamforming antenna and an innovative air interface, RADWIN's systems deliver optimal performance in the toughest conditions including high interference and obstructed line-of-sight.

Deployed in over 170 countries, RADWIN's solutions power applications including backhaul, broadband access, private network connectivity, video surveillance transmission as well as delivering broadband on the move for trains, vehicles and vessels.

The RADWIN name is a registered trademark of RADWIN Ltd. Specifications are subject to change without prior notification. © All rights reserved, January 2018

RADWIN

